

Power ULV Sprayer VIRGUN Manual

VIRGUN POWER

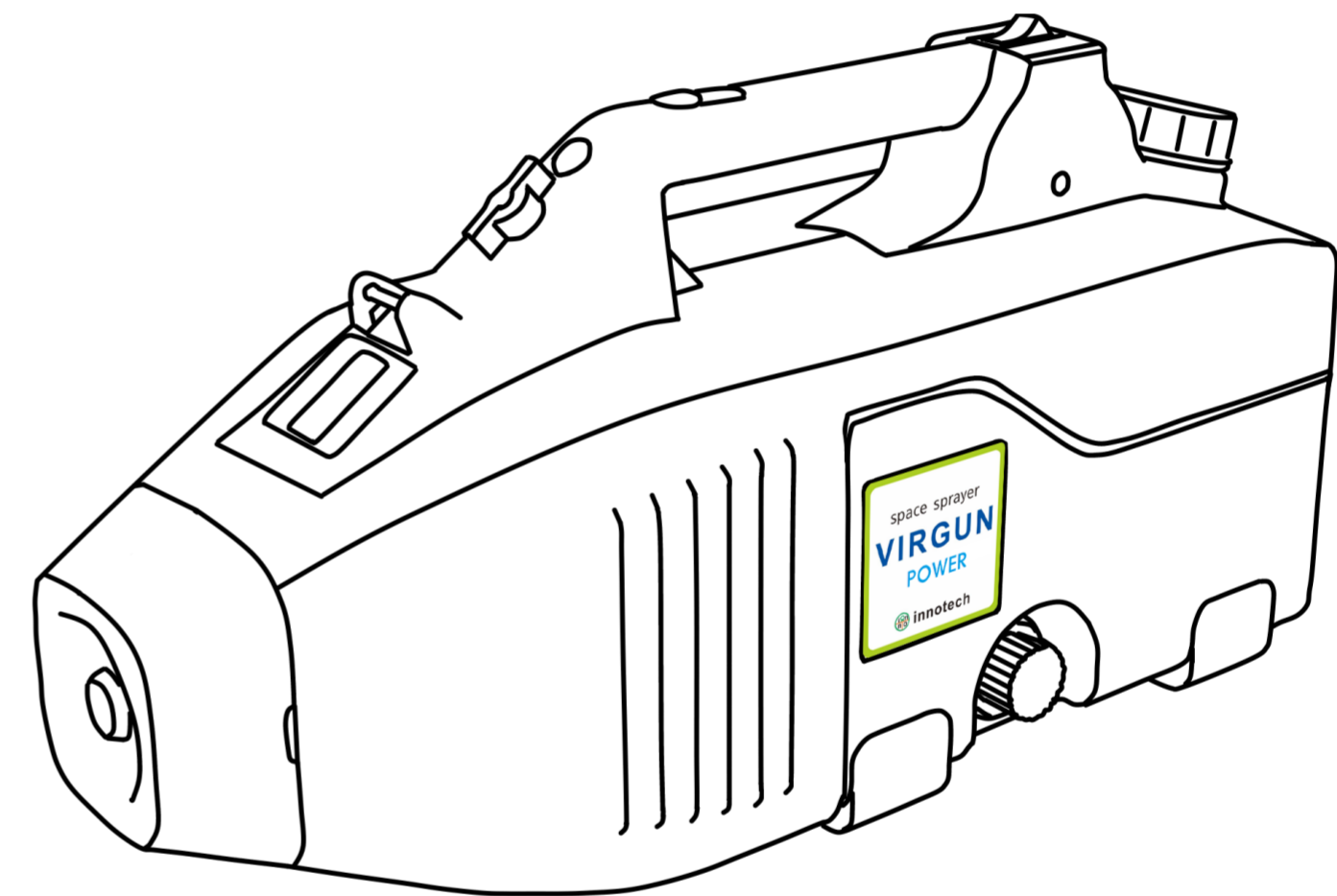

INNOTECH

INNOTECH

www.smartcatch.kr

Product name	Innotech Power ULV Sprayer VIRGUN
Model name	VIRGUN POWER / VGP-2
Spray distance	8~10m
Rated Voltage	220~240Vac, 50/60Hz
Power	1130W
Size / Weight	523X265X180mm / 5kg



Adapter certificate
HU10379-16021B
Electromagnetic number
R-R-bk2-VIRGUN POWER

INNOTECH

Customer center number : 1600-4261



Add : 23, Solbat-ro (Sangpyeong-dong), Jinju-si, Gyeongsangnam-do

- Before use, be sure to read this manual and use it correctly.

■ Precautions for safety

- Be sure to read the precautions indicated in the manual.

■ Product composition

- Main body 1set • User Guide 1ea
- Fuse 1ea • 10m Power cord 1ea

■ Product specification

Model name	VIRGUN POWER
Rated Voltage	220~240Vac, 50/60Hz
Power	1130W
Spray distance	8~10m
Particle Size	10~30 μ m
Size	523X265X180(mm)
Weight	4kg
Usage Time	-
Volume	4L
Dispensing V.	500ml/min
Made	Korea
Manufacturer	Innotech

■ Product main name

- Please refer to the notation below to familiarize yourself with the name before using.

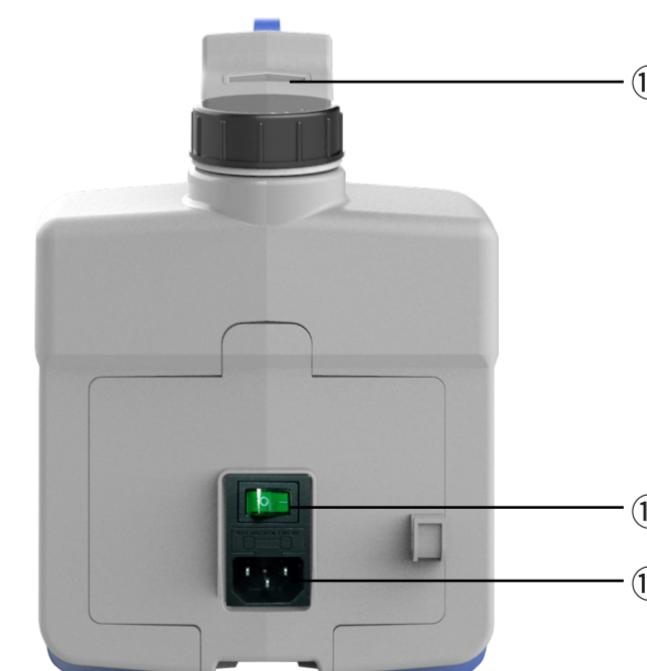
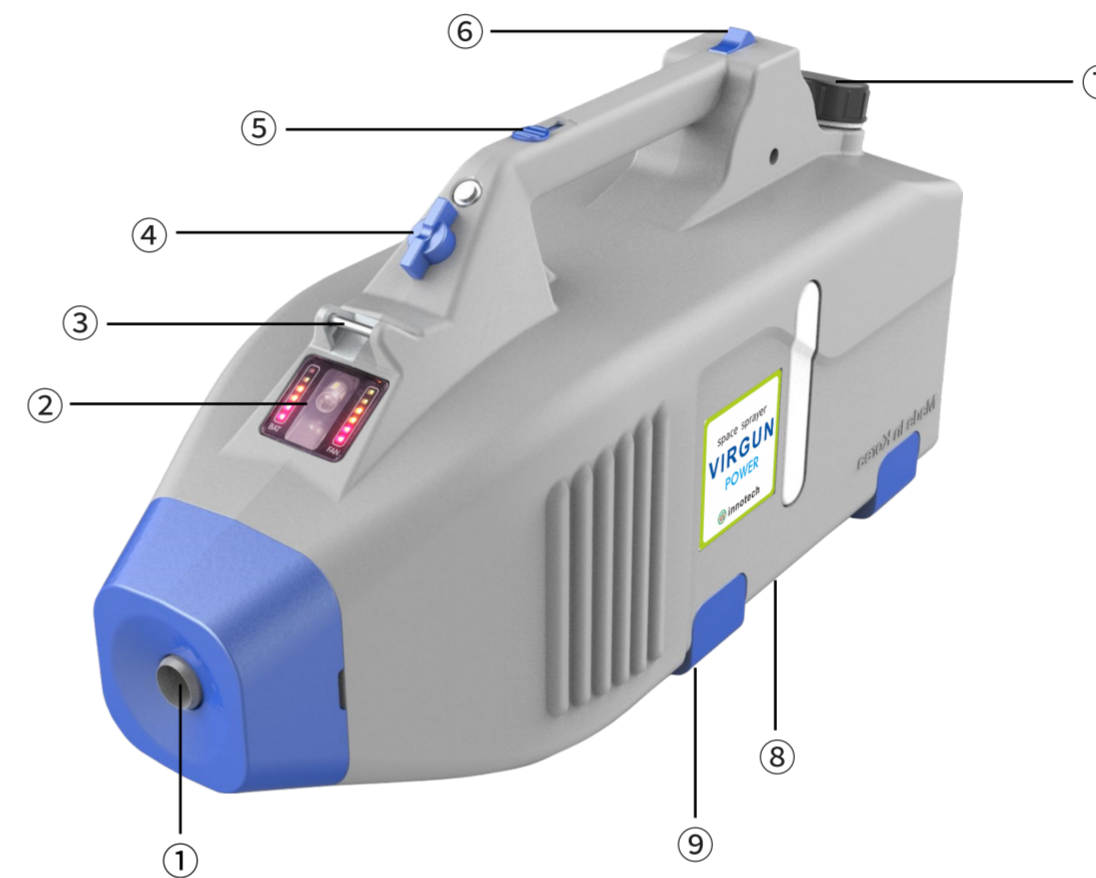

- ① Nozzle
- ② Level window
- ③ Belt Ring
- ④ Control valve
- ⑤ Wind volume control
- ⑥ Belt stopper
- ⑦ Tank Cap
- ⑧ Filter
- ⑨ Rubber feet
- ⑩ Shoulder belt
- ⑪ On-Off Switch
- ⑫ Power Jack

Product Features

- Easily adjust the particle size and spray distance according to the air volume and chemical control.
- Built-in shoulder belt prevents contamination than a detachable belt.
- It is possible to work in dark places by installing an LED flash that is easy for night work.
- 10m power line, power cord detachable
- Equipped with rubber feet to prevent slipping when moving by vehicle.
- By attaching a filter to the outside, clogging of chemicals caused by contamination can be easily removed.



User TIP

- Power cable extension
 - When using an extension cable, use a cable of 250V, 16A, 3CX1.5 or higher.

How to use the product

- I. After filling the drug tank with water and the amount of the drug, completely close the cap (a) of the drug tank.
- II. Put the on/off switch (b) at the bottom of the back to the on position.
- III. Pull the belt loop to fit the body, then fasten the loop and press the stopper (c) to fix the belt.
- IV. Push the air volume control switch (d) to operate the motor.
- V. Turn the drug control valve (e) counterclockwise to inject the drug.
- VI. When finishing the work, proceed in the reverse order of how to use it.

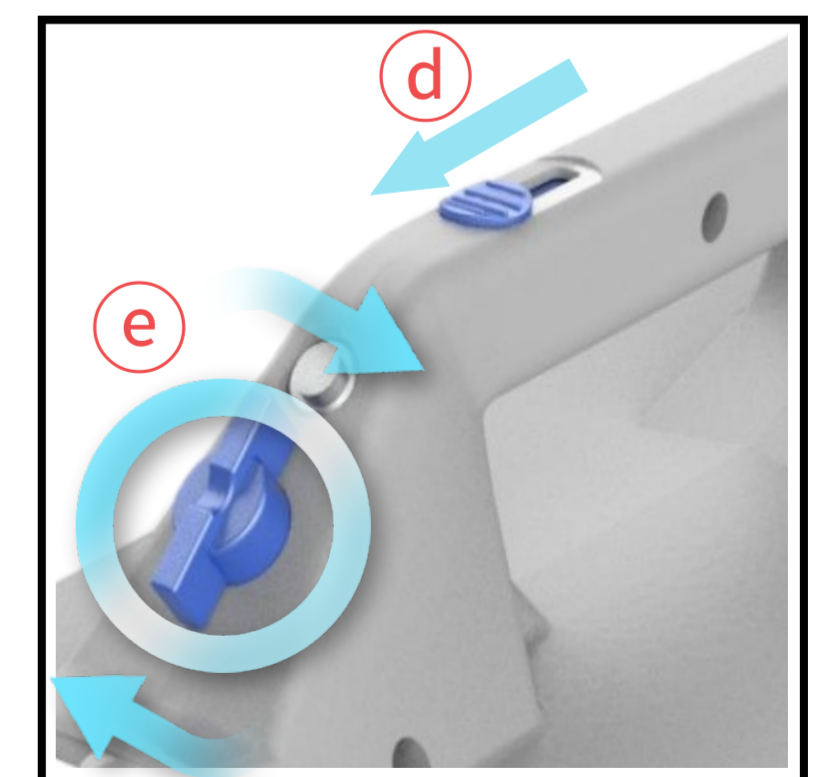
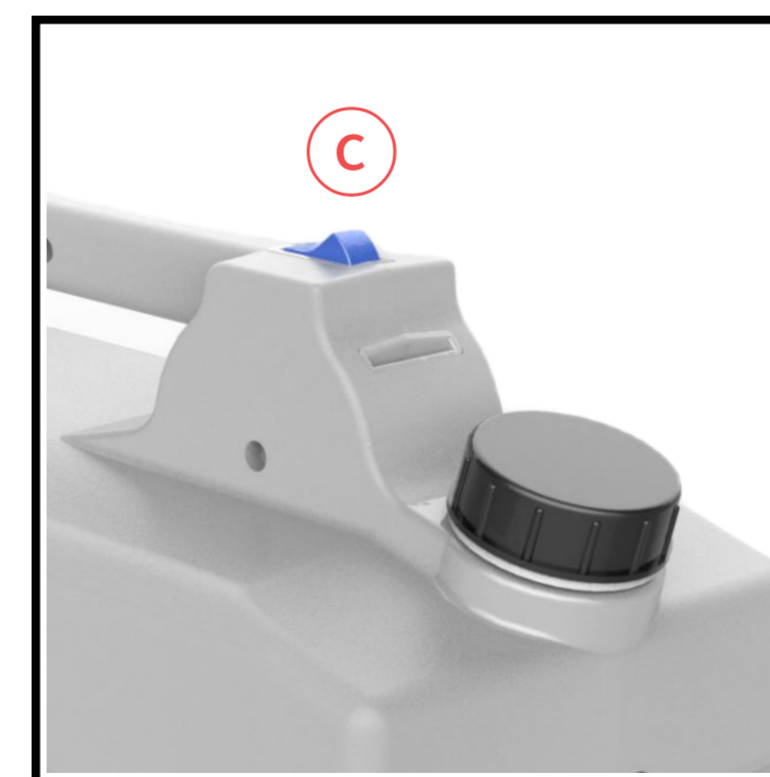
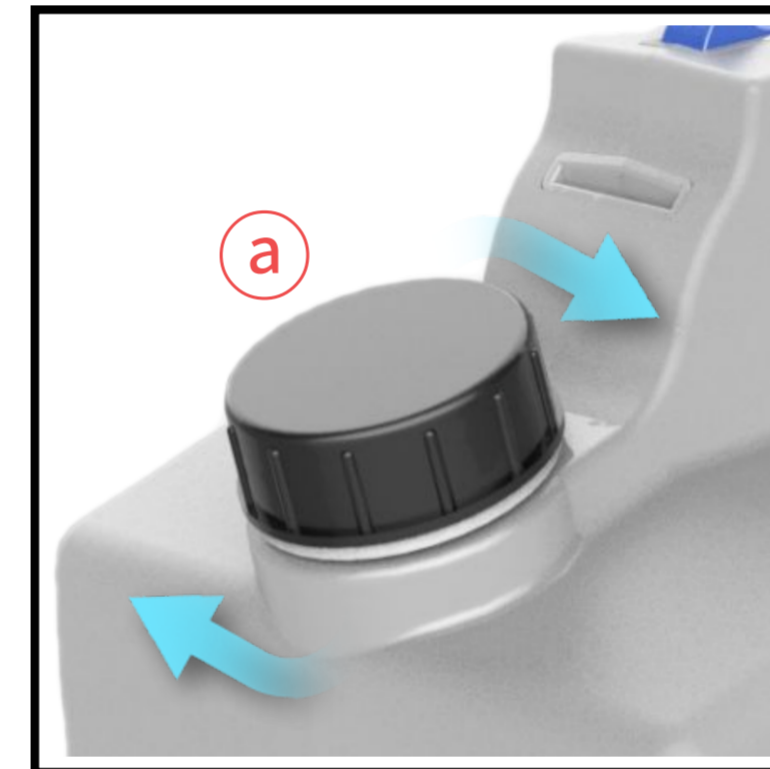

■ Before applying for A/S

Please check before failure.

If the product does not work

- Check the power cable.
- Check the ON, OFF switch.

If the weak body does not spray

- Check if the drug cap is properly closed.
- Please check the pharmaceutical filter network.
- Check if the drug suction hose inside the drug tank is blocked and remove any foreign substances Please use.

If the power does not work

- Check if the main body and outlet are well connected.
- Check if the power cord is firmly plugged into an outlet.
- Check if electricity is supplied to the outlet.
- Check if the charging voltage is 220V.

Etc

- If the same symptom occurs even after doing this, please contact the head office or the sales office.
- It is not an abnormality that heat is generated in the body even during normal operation.
- If a part is deformed due to heat during use, please report a malfunction.

■ Precautions for use

- Do not give physical impact to the product.
- Do not disassemble or modify the product arbitrarily.
- Keep out of reach of infants and children.
- Do not use chemicals that are harmful to the human body.
- When handling or spraying toxic chemicals, wear protective equipment before use.
- Never put inflammable substances in the medicine container.
- When spraying medicines, be careful not to spray them on people
- Do not use a damaged chemical container.
- Do not put foreign objects inside the product.
- Never connect the power when the body is wet or submerged in water.
- Do not use while charging.

■ Precautions for storage

- Do not leave the main body in a closed car, in direct sunlight, or in a hot place such as a heating appliance.
- Do not store in a humid, dusty place, or in a place exposed to water.
- When cleaning, wipe with a soft cloth, not detergent.
- After use, after use, wash with clean water and spray the residue once to remove the residue from the internal medicine container and hose.